

# Product datasheet

Specifications



## Illuminated Switch-5 Function keys with multi-color LEDs backlit

Local distributor code:  
398059886

HMIZRA1

EAN Code: 3595864167152

### Main

Range Of Product	Harmony HMIZ
Product Or Component Type	Illuminated USB switch
Product Compatibility	XBTGC - controller panel XBTGT2... - advanced touch panel HMISTO - touch panel HMISCU - touch panel XBTGT6... - advanced touch panel HMIGTW - advanced touch panel XBTGK - graphic display XBTGT4... - advanced touch panel XBTGT5... - advanced touch panel XBTGT7... - advanced touch panel HMISTU - touch panel HMIGTO - advanced touch panel HMIPSP - S-Panel PC HMIPSO - S-Panel PC HMIBMU - Modular Box PC HMIBMP - Modular Box PC HMIBMO - Modular Box PC HMIBMI - Modular Box PC
Device Application	Food and beverage Industrial machines
Provided Equipment	1 x user manual 1 x USB type B cable clamp 1 x fixing nut 1 x tightening wrench 1 x anti-rotation tee 1 x gasket 1 x insert label 1 x USB cable type A/B (with 1 m)

### Complementary

Software Designation	Vijeo Designer version >= V6.1 SP2
Connector Type	USB type B
Control Type	5 push-buttons with multi-colour backlit LED
Colour Of Cover	Front dark grey cover
[Us] Rated Supply Voltage	5 V DC, connector type: USB 2.0
Supply Voltage Limits	4.75...5.25 V DC
Power Consumption In W	2 W
Shock Resistance	147 m/s <sup>2</sup> for 3 chocks in each direction X, Y and Z conforming to IEC 61131-2

Disclaimer: This documentation is not intended as a substitute for and is not to be used for determining suitability or reliability of these products for specific user applications

Electromagnetic Compatibility	Electrostatic discharge immunity test - test level: 8 kV (air discharge) conforming to IEC 61000-4-2 Electrostatic discharge immunity test - test level: 6 kV (contact discharge) conforming to IEC 61000-4-2 Electrical fast transient/burst immunity test - test level: 2 kV (power ports) conforming to IEC 61000-4-4 Electrical fast transient/burst immunity test - test level: 1 kV (signal ports) conforming to IEC 61000-4-4
Mounting Location	Flat surface
Quantity Per Set	1 piece
Height	54 mm
Width	122 mm
Depth	28 mm
Net Weight	0.11 kg

## Environment

Ambient Air Temperature For Storage	-20...60 °C
Relative Humidity	10...90 % at 0...55 °C non-condensing
Pollution Degree	2
Environmental Characteristic	Corrosive gas free
Operating Altitude	<= 2000 m
Vibration Resistance	3.5 mm (f= 5...9 Hz) conforming to IEC 61131-2
Ip Degree Of Protection	IP65 (front panel (in enclosure))
Nema Degree Of Protection	NEMA 4X for indoor installation installation NEMA 13 for enclosed outdoor installation
Standards	CSA C22.2 No 142 UL 508 CSA C22.2 No 213 EN 61000-6-4 ANSI/ISA 12.12.01 EN 61000-6-2 EMC 2004/108/EC
Product Certifications	GOST UL/cUL listed C-Tick CE
Level Or Class	Class I Division 2 Groups A/B/C/D

## Packing Units

Unit Type Of Package 1	PCE
Number Of Units In Package 1	1
Package 1 Height	7.5 cm
Package 1 Width	13.6 cm
Package 1 Length	18.7 cm
Package 1 Weight	307.5 g

## Contractual warranty

Warranty	18 months
----------	-----------

# Sustainability



**Green Premium™ label** is Schneider Electric’s commitment to delivering products with best-in-class environmental performance. Green Premium promises compliance with the latest regulations, transparency on environmental impacts, as well as circular and low-CO<sub>2</sub> products.

**Guide to assessing product sustainability** is a white paper that clarifies global eco-label standards and how to interpret environmental declarations.

[Learn more about Green Premium >](#)

[Guide to assess a product’s sustainability >](#)

## Well-being performance

 Mercury Free	
 Rohs Exemption Information	<a href="#">Yes</a>
Eu Rohs Directive	Pro-active compliance (Product out of EU RoHS legal scope)
China Rohs Regulation	<a href="#">China RoHS declaration</a>
Weee	The product must be disposed on European Union markets following specific waste collection and never end up in rubbish bins

Dimensions Drawings

Dimensions

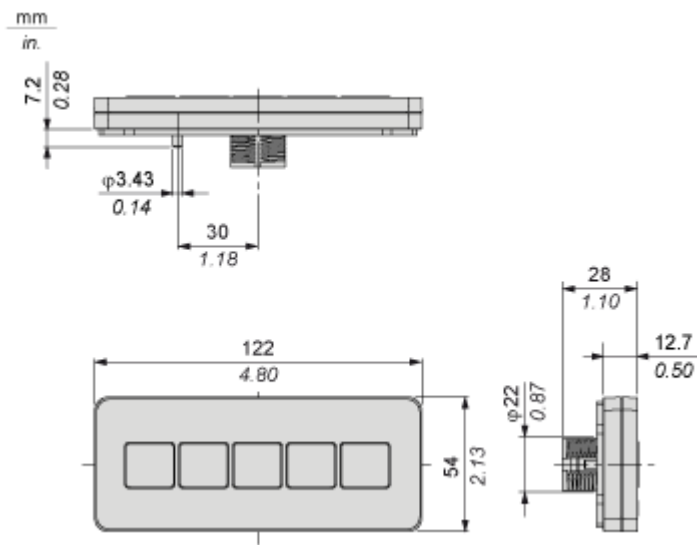

Dimensions with Cable

---

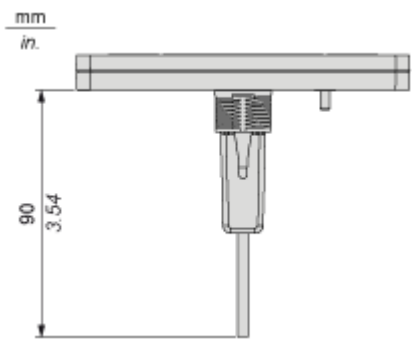

Mounting and Clearance

Mounting of Panel Cut-Out

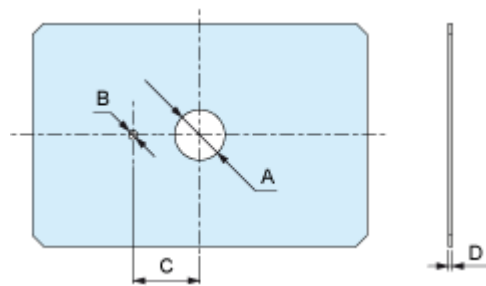

Dimensions in mm

A	B	C	D
22.50 <sub>-0.30</sub>	4 <sub>-0.20</sub>	30 <sub>-0.20</sub>	1.5...6

Dimensions in in.

A	B	C	D
0.88 <sub>-0.01</sub>	0.15 <sub>-0.007</sub>	1.18 <sub>-0.007</sub>	0.06...0.23